

Estratto Catalogo Listino 01/2025

Gamma POLO-KAL XS

PURE
PROGRESS / **poloplast**

Strato esterno in PP/C

Miscela di polipropilene particolarmente resistente agli urti anche in condizioni di temperatura estrema e con una significativa tenuta agli agenti atmosferici

Strato intermedio in PP/MV

La fibra minerale conferisce grande elasticità garantendo il contenimento dell'energia sonora tramite il principio fisico di «massa/molla/massa»

Strato interno in PP/C

Miscela di polipropilene perfettamente liscia stabile sino a 95°C e resistente alle frizioni

funTEC technology

Guarnizione elastomerica integrata nel bicchiere per un innesto rapido e sicuro senza impiego di lubrificante o necessità di smussatura post taglio

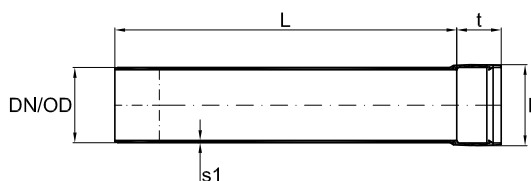

XSEM Tubo stratificato con 1 bicchiere

Codice	DN	D max	L mm.	S1-min mm.	t-min mm.	Peso Kg./pz.	Conf. Pezzi	Conf. Bancale	€/Pz.
XS032250 102001	32	37	250	1,8	41,0	0,06	20	1200	3,55
XS032500 102002	32	37	500	1,8	41,0	0,11	20	400	4,70
XS031000 102003	32	37	1000	1,8	41,0	0,21	10	720	7,25
XS031500 102004	32	37	1500	1,8	41,0	0,30	10	300	11,35
XS032000 102005	32	37	2000	1,8	41,0	0,40	10	300	13,80
XS033000 102006	32	37	3000	1,8	41,0	0,59	10	300	20,90
XS040150 102010	40	45	150	1,8	45,0	0,06	20	1200	3,35
XS040250 102011	40	45	250	1,8	45,0	0,09	20	800	3,55
XS040500 102012	40	45	500	1,8	45,0	0,15	20	400	4,70
XS041000 102013	40	45	1000	1,8	45,0	0,28	10	480	7,25
XS041500 102014	40	45	1500	1,8	45,0	0,40	10	280	11,35
XS042000 102015	40	45	2000	1,8	45,0	0,53	10	280	13,80
XS043000 102016	40	45	3000	1,8	45,0	0,79	10	280	20,90
XS050150 102020	50	55	150	2,0	47,0	0,08	20	800	3,45
XS050250 102021	50	55	250	2,0	47,0	0,11	20	720	3,65
XS050500 102022	50	55	500	2,0	47,0	0,20	20	400	4,90
XS051000 102023	50	55	1000	2,0	47,0	0,37	10	390	7,25
XS051500 102024	50	55	1500	2,0	47,0	0,54	10	240	12,00
XS052000 102025	50	55	2000	2,0	47,0	0,71	10	240	15,00
XS053000 102026	50	55	3000	2,0	47,0	1,09	10	240	23,40
XS070250 102031	75	82	250	2,6	53,0	0,23	20	360	6,55
XS070500 102032	75	82	500	2,6	53,0	0,39	20	240	8,80
XS071000 102033	75	82	1000	2,6	53,0	0,77	8	160	12,15
XS071500 102034	75	82	1500	2,6	53,0	1,29	8	96	17,80
XS072000 102035	75	82	2000	2,6	53,0	1,50	8	96	23,00
XS073000 102036	75	82	3000	2,6	53,0	2,26	8	96	34,00
XS090250 102071	90	98	250	3,0	59,0	0,31	20	180	8,40
XS090500 102072	90	98	500	3,0	59,0	0,56	20	80	12,75
XS091000 102073	90	98	1000	3,0	59,0	1,11	6	144	19,75
XS091500 102074	90	98	1500	3,0	59,0	1,63	6	96	27,90
XS092000 102075	90	98	2000	3,0	59,0	2,15	6	96	37,20
XS093000 102076	90	98	3000	3,0	59,0	3,21	6	96	53,30
XS110250 102041	110	116	250	3,4	65,0	0,45	20	120	8,65
XS110500 102042	110	116	500	3,4	65,0	0,82	20	80	12,95
XS111000 102043	110	116	1000	3,4	65,0	1,54	4	84	20,10
XS111500 102044	110	116	1500	3,4	65,0	2,24	4	48	28,40
XS112000 102045	110	116	2000	3,4	65,0	2,96	4	48	38,00
XS113000 102046	110	116	3000	3,4	65,0	4,40	4	48	54,80

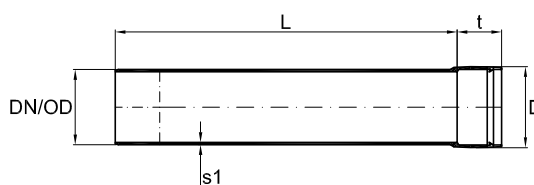
XSEM Tubo stratificato con 1 bicchiere

Codice	DN	D max	L mm.	S1-min mm.	t-min mm.	Peso Kg./pz.	Conf. Pezzi	Conf. Bancale	€/Pz.
XS125250 102051	125	135	250	3,9	--	0,59	1	10	13,05
XS125500 102052	125	135	500	3,9	--	1,03	1	45	18,70
XS121000 102053	125	135	1000	3,9	--	1,91	1	40	29,80
XS122000 102055	125	135	2000	3,9	--	3,67	1	40	54,90
XS123000 102056	125	135	3000	3,9	--	5,43	1	40	76,50
<input type="checkbox"/> XS160250 102061	160	173	250	4,9	--	0,99	1	56	18,30
<input type="checkbox"/> XS160500 102062	160	173	500	4,9	--	1,69	1	28	28,50
<input type="checkbox"/> XS161000 102063	160	173	1000	4,9	--	3,01	1	36	44,30
<input type="checkbox"/> XS162000 102065	160	173	2000	4,9	--	5,93	1	36	82,10
<input type="checkbox"/> XS163000 102066	160	173	3000	4,9	--	8,75	1	36	116,50

POLO-KAL XS

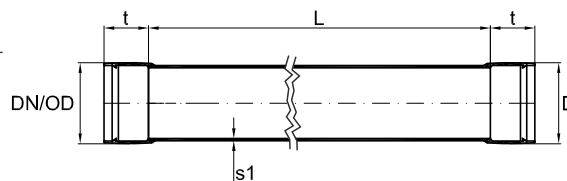
XSDM Tubo stratificato con 2 bicchieri

Codice	DN	D max	L mm.	S1-min mm.	t-min mm.	Peso Kg./pz.	Conf. Pezzi	Conf. Bancale	€/Pz.
XSD31000 101951	32	37	1000	1,8	41,0	0,22	10	720	8,55
XSD32000 101953	32	37	2000	1,8	41,0	0,41	10	300	16,30
XSD33000 101954	32	37	3000	1,8	41,0	0,60	10	300	24,30
XSD41000 101956	40	45	1000	1,8	45,0	0,28	10	480	8,55
XSD42000 101958	40	45	2000	1,8	45,0	0,53	10	280	16,30
XSD43000 101959	40	45	3000	1,8	45,0	0,77	10	280	24,30
XSD51000 101961	50	55	1000	2,0	47,0	0,39	10	390	8,70
XSD52000 101963	50	55	2000	2,0	47,0	0,74	10	240	17,80
XSD53000 101964	50	55	3000	2,0	47,0	1,08	10	240	27,10
XSD71000 101966	75	82	1000	2,6	53,0	0,74	8	160	14,50
XSD72000 101968	75	82	2000	2,6	53,0	1,48	8	96	27,20
XSD73000 101969	75	82	3000	2,6	53,0	2,16	8	96	39,50
XSD91000 101971	90	98	1000	3,0	59,0	1,16	6	144	23,50
XSD92000 101973	90	98	2000	3,0	59,0	2,18	6	96	43,60
XSD93000 101974	90	98	3000	3,0	59,0	3,19	6	96	61,40
XSD11100 101976	110	116	1000	3,4	65,0	1,58	4	84	24,10
XSD11200 101978	110	116	2000	3,4	65,0	2,92	4	48	44,50
XSD11300 101979	110	116	3000	3,4	65,0	4,26	4	48	62,50

XSB Curva

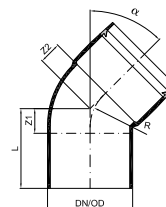

Codice	DN	α	Z1 mm.	Z2 mm.	R mm.	L mm.	Peso Kg./pz.	Conf. Pezzi	Conf. Bancale	€/Pz.	
XS032015	102100	32	15°	3,0	9,0	18,0	44,0	0,03	20	2000	3,00
XS032030	102101	32	30°	5,0	12,0	18,0	46,0	0,01	20	2000	3,00
XS032045	102102	32	45°	7,0	13,0	18,0	48,0	0,03	20	2000	2,80
XS032067	102103	32	67,5°	12,0	18,0	18,0	53,0	0,02	20	2000	3,35
XS032087	102104	32	87,5°	16,0	20,0	18,0	57,0	0,02	20	2000	3,00
XS040015	102110	40	15°	6,0	10,0	21,0	51,0	0,03	20	2000	3,00
XS040030	102111	40	30°	9,0	12,0	21,0	54,0	0,03	20	2000	3,00
XS040045	102112	40	45°	12,0	16,0	21,0	57,0	0,04	20	2000	2,80
XS040067	102113	40	67,5°	18,0	19,0	21,0	63,0	0,04	20	2000	3,35
XS040087	102114	40	87,5°	24,0	27,0	21,0	69,0	0,04	20	1200	3,00
XS050015	102120	50	15°	9,0	12,0	27,0	54,0	0,05	20	1200	3,95
XS050030	102121	50	30°	10,0	14,0	27,0	59,0	0,05	20	1200	3,55
XS050045	102122	50	45°	15,0	17,0	27,0	63,0	0,05	20	1200	3,45
XS050067	102123	50	67,5°	22,0	22,0	26,0	70,0	0,05	20	1200	4,85
XS050087	102124	50	87,5°	29,0	32,0	27,0	78,0	0,06	20	800	3,90
XS070015	102130	75	15°	10,0	11,0	40,0	64,0	0,10	20	480	6,20
XS070030	102131	75	30°	16,0	16,0	40,0	69,0	0,11	20	480	6,20
XS070045	102132	75	45°	21,0	22,0	40,0	75,0	0,12	20	480	6,20
XS070067	102133	75	67,5°	31,0	31,0	40,0	86,0	0,13	20	480	8,40
XS070087	102134	75	87,5°	43,0	44,0	40,0	97,0	0,14	20	360	8,05
XS090015	102170	90	15°	14,0	10,0	47,0	72,0	0,15	20	360	9,20
XS090030	102171	90	30°	20,0	16,0	47,0	78,0	0,16	20	360	9,20
XS090045	102172	90	45°	26,0	23,0	47,0	84,0	0,17	20	360	8,80
XS090067	102173	90	67,5°	37,0	36,0	47,0	96,0	0,19	20	240	10,00
XS090087	102174	90	87,5°	51,0	47,0	47,0	109,0	0,21	20	240	9,30
XS110015	102140	110	15°	15,0	13,0	58,0	80,0	0,27	20	180	9,30
XS110030	102141	110	30°	23,0	23,0	58,0	88,0	0,29	20	180	9,30
XS110045	102142	110	45°	32,0	31,0	58,0	96,0	0,31	20	180	8,70
XS110067	102143	110	67,5°	44,0	44,0	58,0	111,0	0,31	20	180	10,10
XS110087	102144	110	87,5°	63,0	63,0	58,0	128,0	0,34	20	180	9,30
XS125015	102150	125	15°	--	--	--	--	0,32	20	180	17,80
XS125030	102151	125	30°	--	--	--	--	0,35	20	120	17,80
XS125045	102152	125	45°	--	--	--	--	0,42	20	160	17,80
XS125087	102154	125	87,5°	--	--	--	--	0,46	20	80	26,10
XS160015	102160	160	15°	--	--	--	--	0,66	10	60	27,70
XS160030	102161	160	30°	--	--	--	--	0,72	10	60	27,70
XS160045	102162	160	45°	--	--	--	--	0,85	10	80	27,70
XS160087	102164	160	87,5°	--	--	--	--	0,89	10	40	42,70

XSEA Braga

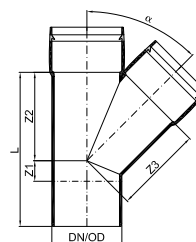

Codice	DN D/D1	α	Z1 mm.	Z2 mm.	Z3 mm.	L mm.	Peso Kg./pz.	Conf. Pezzi	Conf. Bancale	€/Pz.
XS030345 102200	32/32	45°	7,0	47,0	47,0	95,0	0,04	10	1000	6,40
XS040345 102203	40/32	45°	7,0	51,0	53,0	102,0	0,04	10	1000	6,60
XS040445 102206	40/40	45°	12,0	55,0	55,0	113,0	0,07	10	600	6,60
XS050345 102209	50/32	45°	2,0	56,0	60,0	106,0	0,06	10	600	8,10
XS050445 102212	50/40	45°	8,0	60,0	63,0	117,0	0,09	10	400	8,10
XS050545 102215	50/50	45°	15,0	67,0	67,0	131,0	0,10	10	400	8,10
XS070545 102218	75/50	45°	4,0	82,0	86,0	139,0	0,18	10	240	11,15
XS070745 102221	75/75	45°	21,0	99,0	99,0	174,0	0,25	10	180	11,15
XS090545 102210	90/50	45°	-2,0	88,0	95,0	144,0	0,24	10	180	18,15
XS090945 102211	90/90	45°	26,0	114,0	114,0	198,0	0,38	10	120	18,40
XS110545 102224	110/50	45°	-11,0	101,0	111,0	155,0	0,35	10	180	18,40
XS110745 102227	110/75	45°	7,0	119,0	125,0	191,0	0,46	10	120	18,60
XS110945 102839	110/90	45°	22,0	134,0	136,0	220,0	0,51	10	90	18,50
XS111145 102230	110/110	45°	32,0	146,0	146,0	243,0	0,66	10	80	18,60
XS121145 102236	125/110	45°	--	--	--	--	0,83	10	80	42,70
XS121245 102239	125/125	45°	--	--	--	--	0,89	10	40	64,60
□ XS161145 102242	160/110	45°	--	--	--	--	1,15	5	45	67,00
○ □ XS161245 102240	160/125	45°	--	--	--	--	1,39	5	40	136,00
□ XS161645 102245	160/160	45°	--	--	--	--	1,74	5	20	101,00

XS040467 102207	40/40	67,5°	17,0	38,0	37,0	100,0	0,06	10	600	6,60
XS050567 102216	50/50	67,5°	22,0	45,0	45,0	116,0	0,09	10	400	8,10
XS090967 102831	90/90	67,5°	36,0	78,0	79,0	173,0	0,32	10	120	18,40
XS111167 102231	110/110	67,5°	46,0	96,0	93,0	207,0	0,53	10	90	18,60

XS040487 102208	40/40	87,5°	24,0	27,0	27,0	95,0	0,06	10	600	6,60
XS050487 102214	50/40	87,5°	25,0	27,0	32,0	100,0	0,07	10	600	8,10
XS050587 102217	50/50	87,5°	30,0	32,0	32,0	110,0	0,08	10	400	8,10
XS070587 102220	75/50	87,5°	30,0	34,0	45,0	118,0	0,15	10	360	11,15
XS070787 102223	75/75	87,5°	43,0	46,0	46,0	143,0	0,20	10	240	11,15
XS090587 102830	90/50	87,5°	30,0	37,0	54,0	125,0	0,21	10	240	18,15
★ XS090987 102248	90/90	87,5°	50,0	54,0	54,0	162,0	0,30	10	180	18,40
XS110587 102226	110/50	87,5°	33,0	37,0	63,0	134,0	0,32	10	180	18,40
XS110787 102229	110/75	87,5°	46,0	50,0	65,0	160,0	0,39	10	120	18,60
XS110987 102836	110/90	87,5°	74,0	61,0	79,0	199,0	0,42	10	120	18,50
★ XS111187 102232	110/110	87,5°	63,0	70,0	70,0	197,0	0,50	10	120	18,60
XS121187 102238	125/110	87,5°	--	--	--	--	0,76	10	80	42,70
XS121287 102241	125/125	87,5°	--	--	--	--	0,69	10	60	64,60
□ XS161187 102244	160/110	87,5°	--	--	--	--	1,11	5	45	67,00
□ XS161687 102247	160/160	87,5°	--	--	--	--	1,51	5	40	101,00

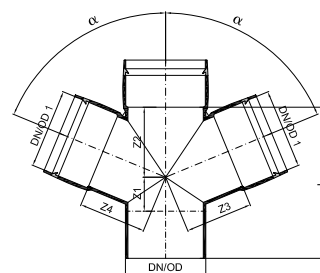
XSDA Braga doppia 67,5°

	Codice	DN D/D1	α	Z1 mm.	Z2 mm.	Z3 mm.	Z4 mm.	L mm.	Peso Kg./pz.	Conf. Pezzi	Conf. Bancale	€/Pz.
○	XSDA0905 102848	90/50/50	67,5°	26,0	70,0	82,0	82,0	155,0	0,31	10	180	32,50
	XSDA1105 102260	110/50/50	67,5°	14,0	62,0	78,0	78,0	139,0	0,36	10	120	31,50
	XSDA0110 102261	110/110/110	67,5°	46,0	99,0	93,0	93,0	207,0	0,67	10	80	37,80

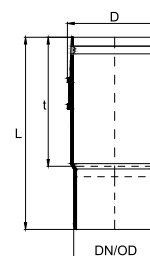
XSL Bicchiera a 3 lunghezze

	Codice	DN	t mm.	L mm.	Peso Kg./pz.	Conf. Pezzi	Conf. Bancale	€/Pz.
	XSLL0040 102331	40	104,0	158,0	0,04	10	1000	4,70
	XSLL0050 102332	50	119,0	174,0	0,06	10	600	6,30
	XSLL0070 102333	75	134,0	197,0	0,15	10	360	9,05
	XSLL0090 102338	90	142,0	212,0	0,35	10	240	14,10
	XSLL0110 102334	110	165,0	243,0	0,34	10	180	14,20
	XSLL0125 102335	125	--	--	0,68	10	120	19,20
□	XSLL0160 102336	160	--	--	1,19	10	40	35,80

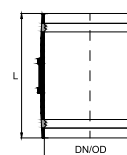
XSU Manicotto scorrevole

	Codice	DN	L mm.	Peso Kg./pz.	Conf. Pezzi	Conf. Bancale	€/Pz.
	XSU00032 102310	32	97,0	0,02	10	1500	4,40
	XSU00040 102311	40	97,0	0,03	10	1500	4,40
	XSU00050 102312	50	103,0	0,04	10	1000	4,60
	XSU00070 102313	75	114,0	0,10	10	400	6,20
	XSU00090 102319	90	124,0	0,14	10	360	10,30
	XSU00110 102314	110	137,0	0,21	10	240	10,40
	XSU00125 102315	125	--	0,34	20	180	19,60
□	XSU00160 102316	160	--	0,64	1	60	29,50

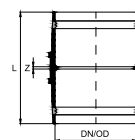
XSMM Manicotto con battente

Codice	DN	L mm.	Z mm.	Peso Kg./pz.	Conf. Pezzi	Conf. Bancale	€/Pz.
XSMM0040 102301	40	97,0	2,0	0,03	10	1500	4,40
XSMM0050 102302	50	103,0	2,0	0,04	10	1000	4,60
XSMM0070 102303	75	114,0	3,0	0,10	10	400	6,20
XSMM0090 102307	90	124,0	3,0	0,14	10	360	10,30
XSMM0110 102304	110	137,0	2,0	0,21	10	240	10,40

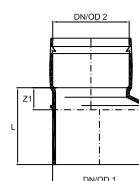
XSRL Aumento

Codice	DN	L mm.	Z mm.	Peso Kg./pz.	Conf. Pezzi	Conf. Bancale	€/Pz.
XS032040 102280	32/40	67,0	26,0	0,02	20	2000	4,70
XS032050 102281	32/50	75,0	26,0	0,03	20	1200	4,70
XS040050 102282	40/50	65,0	20,0	0,04	20	1200	4,60
XS050075 102283	50/75	82,0	29,0	0,08	20	720	6,00
XS050090 102885	50/90	93,0	35,0	0,11	20	480	12,80
XS050110 102284	50/110	79,0	53,0	0,18	20	360	8,70
XS075090 102886	75/90	79,0	21,0	0,13	20	480	10,70
XS075110 102285	75/110	102,0	37,0	0,20	20	480	8,80
XS090110 102887	90/110	90,0	26,0	0,13	20	360	11,60
XS110125 102286	110/125	--	--	0,28	20	180	15,60
<input type="checkbox"/> XS110160 102287	110/160	--	--	0,45	20	180	23,70
<input type="checkbox"/> XS120160 102288	125/160	--	--	0,46	20	180	23,80

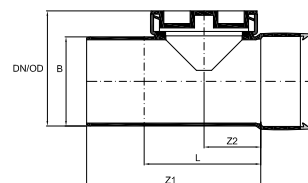
XSRE Ispezione

Codice	DN	L mm.	Z1 mm.	Z2 mm.	B mm.	Peso Kg./pz.	Conf. Pezzi	Conf. Bancale	€/Pz.
XSRE0050 102342	50	118,0	70,0	35,0	63,0	0,09	10	600	14,40
XSRE0070 102343	75	158,0	104,0	53,0	94,0	0,24	10	360	17,75
XSRE0090 102347	90	176,0	118,0	57,0	116,0	0,38	10	180	26,20
XSRE0110 102344	110	208,0	144,0	78,0	138,0	0,60	10	120	26,40
XSRE0125 102345	125	--	--	--	--	0,70	10	60	53,00
<input type="checkbox"/> XSRE0160 102346	160	--	--	--	--	1,11	5	60	81,50

XSASV Collare antisfilamento solo per sistemi POLO-KAL XS e POLO-KAL 3S

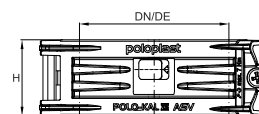
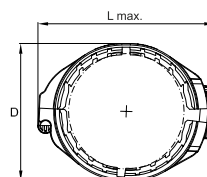

Codice	DN	DE mm.	H mm.	L max mm.	Resistenza sfilamento	Pressione massima interna	Peso Kg./pz.	Conf. Pezzi	Conf. Bancale	€/Pz.
XSANTI32 101750	32	44,0	34,0	65,0	100 Kg.	2,5 bar	0,03	10	1500	6,85
XSANTI40 101751	40	52,0	36,0	78,0	100 Kg.	2,5 bar	0,04	10	1500	7,40
XSANTI50 101752	50	62,0	38,0	89,0	100 Kg.	2,5 bar	0,10	10	1500	9,50
XSANTI75 101753	75	91,0	43,0	118,0	130 Kg.	2,5 bar	0,14	10	1000	11,50
XSANTI90 101754	90	107,0	46,0	138,0	130 Kg.	2,0 bar	0,21	10	600	13,00
XSANTI111 101755	110	128,0	50,0	161,0	130 Kg.	2,0 bar	0,21	10	600	20,00
XSANTI112 101756	125	--	--	--	250 Kg.	--	0,24	10	360	46,00
<input type="checkbox"/> XSANTI16 101757	160	--	--	--	400 Kg.	--	0,37	10	240	60,00

COMPLETAMENTO articoli gamma POLO-KAL NG con la gamma POLO-KAL XS

- **NGRR** Aumento corto a Pag. 41 del presente listino
- **NGRS** Riduzione speciale a Pag. 41 del presente listino
- **NGEHP** Tubo con ispezione per la pulizia a Pag. 42 del presente listino
- **NGSB** Curva prolungata WC a pavimento a Pag. 42 del presente listino
- **NGSK** Manicotto WC a Pag. 42 del presente listino
- **NGS** Raccordo tecnico diritto con morsetto Pag. 42 del presente listino
- **NGSW** Curva tecnica con morsetto a Pag. 43 del presente listino
- **NGSWPR** Curva tecnica prolungata con morsetto a Pag. 43 del presente listino